

Data sheet 50SQ2.75-52

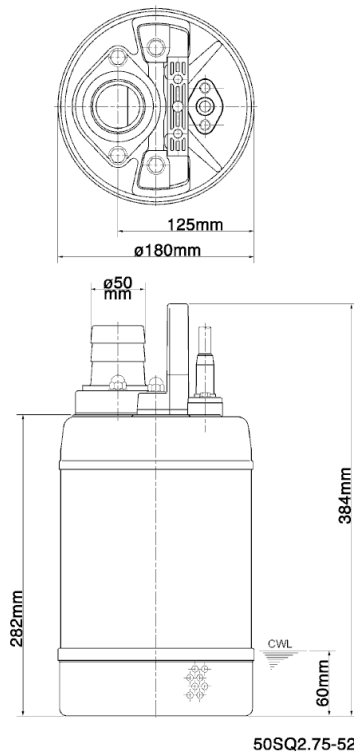

CWL: Continuous running water level

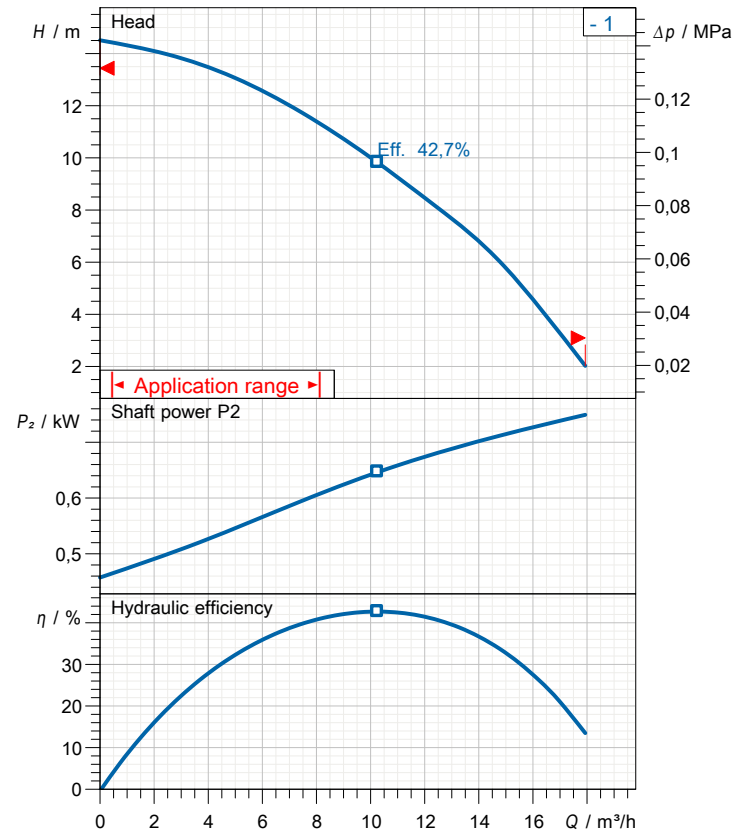

Specification

Elektrische Tauchpumpe SQ-Serie
 Degree of protection IP 68
 Pressure resistance max. 10 m
 Type of impeller Semi-open
 Max. solid handling 6 mm
 Suitable for:
 corrosive liquids and food

Electric motor

Dry-type submersible induction motor
 Insulation class E 2 Poles 2806 1/min
 Starting mode Direct starting
 Rated voltage 400 V 50 Hz 3~
 Power uptake 1,18 kW
 Rated power 0,75 kW
 Rated current 1,8 A
 Start current 9,0 A

Cable

10m H07RN-F 4Cx1,5mm²

Motor Protection

Miniature protector in windings
 (snap-action bi-metal device)

Shaft seal

Double inside mechanical seal in oil bath
 additional lubrication by oil lifting device
 Primary seal
 Silicon carbide on ceramic
 Secondary seal
 Ceramic on carbon

Bearings

Shielded ball bearings, maintenance-free

Materials

Impeller	SCS13 (DIN GX5CrNi19-10)
Pump casing	SCS13 (DIN GX5CrNi19-10)
Strainer	SUS304 (EN-X5CrNi18-10)
Suction cover	SUS304 (EN-X5CrNi18-10)
Motor Frame	SUS304 (EN-X5CrNi18-10)
Shaft	SUS304 (EN-X5CrNi18-10)

Discharge size

50mm hose coupling

Weight

14 kg (dry weight of the pump only without cable)

Performance curve

50SQ2.75-52

Discharge port	2"
FördH	14,5 m
Flow	17,9 m³/h
Rated power	0,75 kW
Power input	1,18 kW
Phases	3~
Voltages	400 V
Frequency	50 Hz
Rated current	1,8 A
Starting current	9,00 A
Number of poles	2
Speed	2806 1/min
Starting mode	Direct starting
Insulation class	E

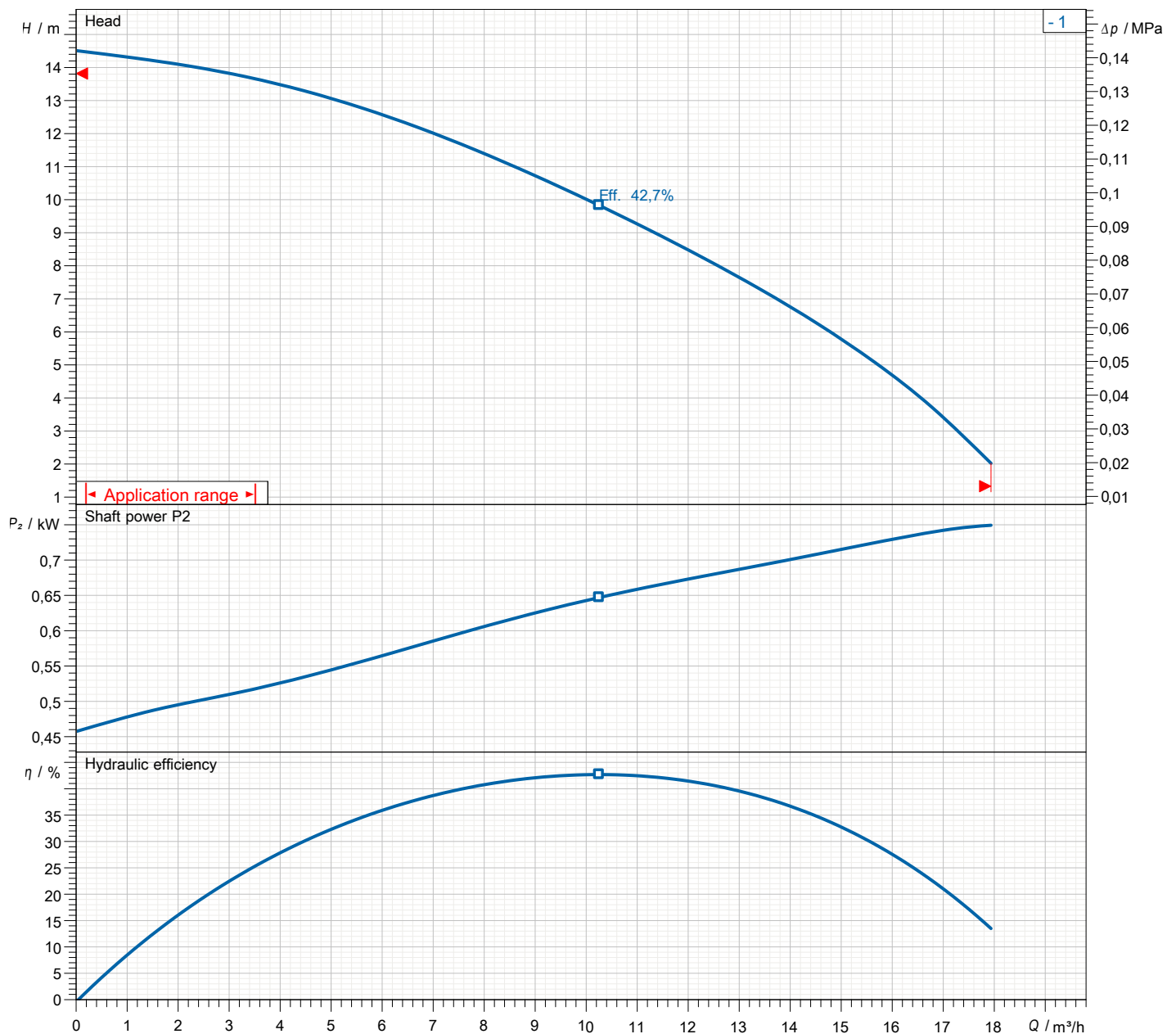

Dimensions

50SQ2.75-52

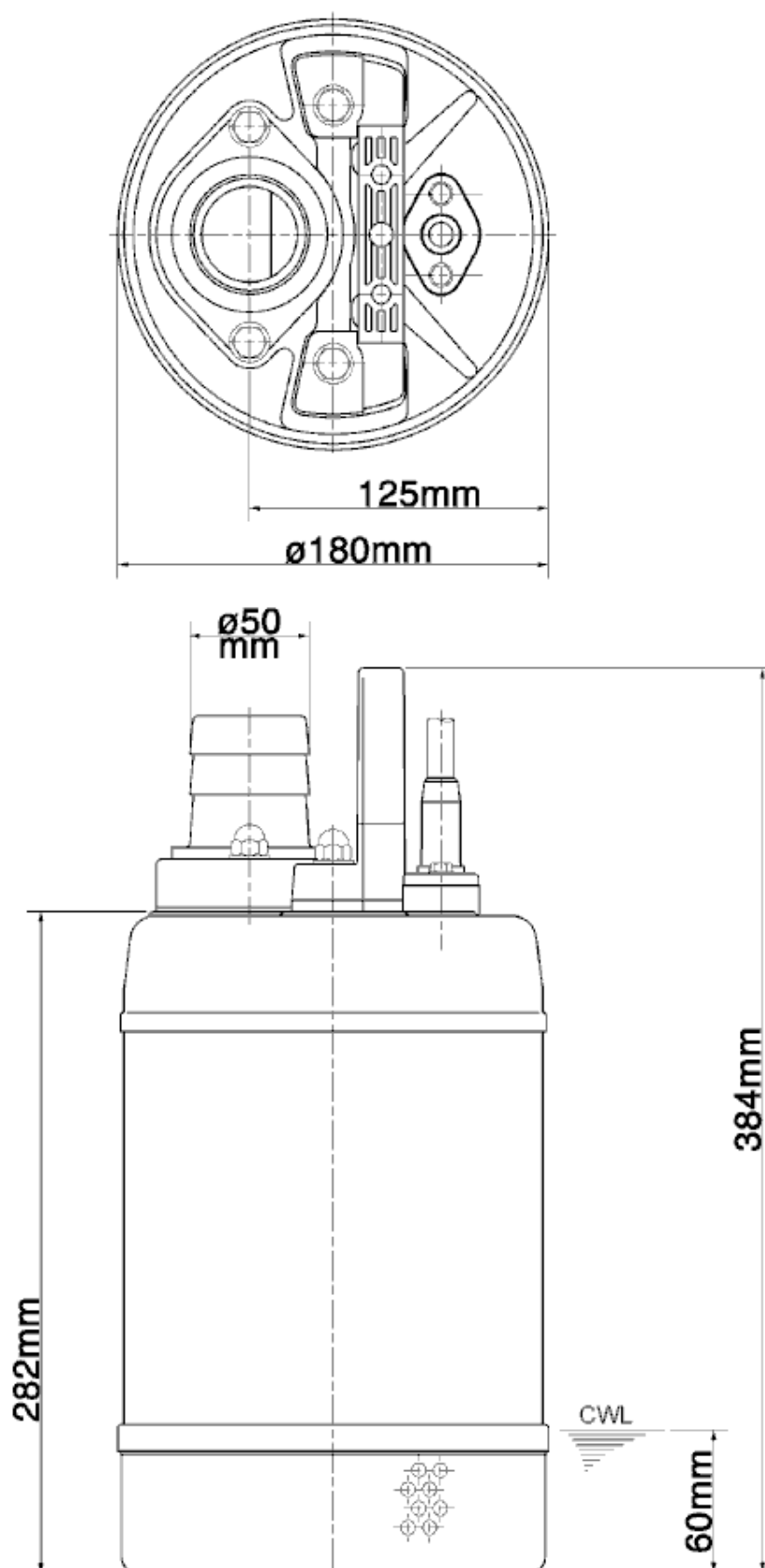

50SQ2.75-52

CWL: Continuous running water level
LWL: Lowest running water level

Sectional drawing 50SQ2.75-52

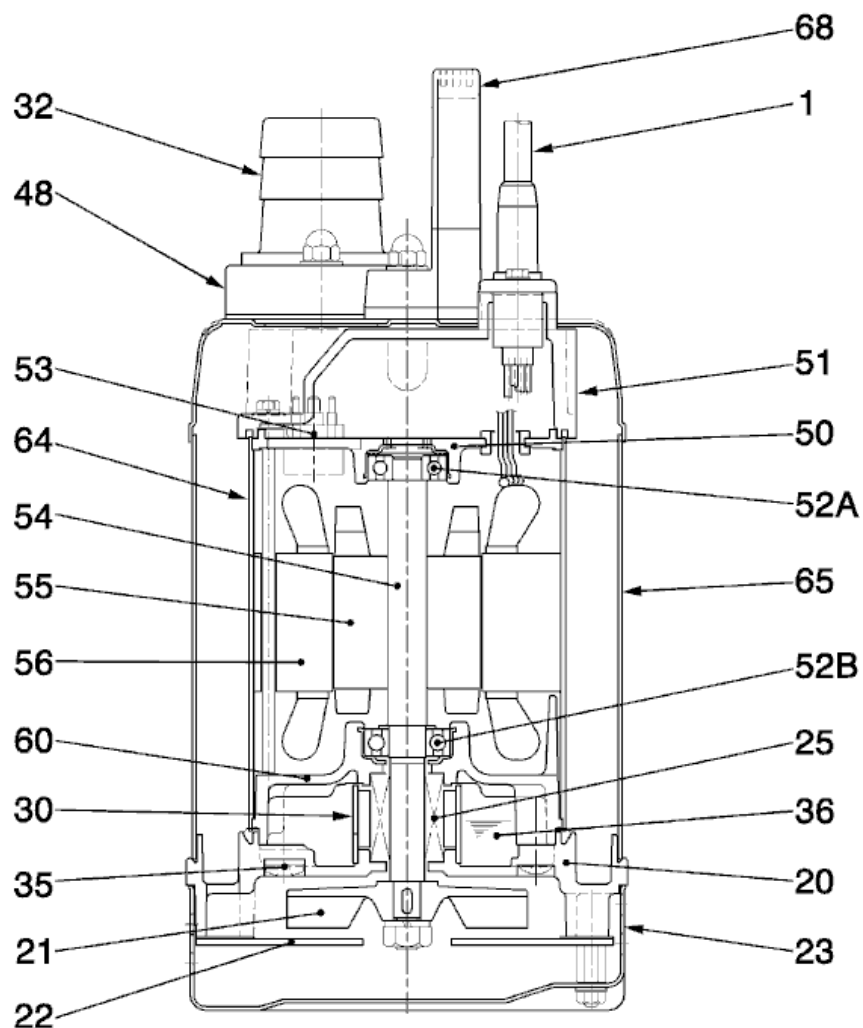

50SQ2.75-52 (A-09942-1)

No.	Description	Remark	No.	Description	Remark
1	Cable	H07RN-F	54	Shaft	SUS304 (EN-X5CrNi18-10)
20	Pump casing	SCS13 (DIN GX5CrNi19-10)	55	Rotor	.
21	Impeller	SCS13 (DIN GX5CrNi19-10)	56	Stator	.
22	Suction cover	SUS304 (EN-X5CrNi18-10)	60	Bearing Housing	Aluminium die casting
23	Strainer	SUS304 (EN-X5CrNi18-10)	64	Motor Frame	SUS304 (EN-X5CrNi18-10)
25	Mechanical seal	W-14HL	65	Outer Cover	SUS304 (EN-X5CrNi18-10)
30	Oil distributor	Plastic	68	Handle	Plastic
32	Hose coupling	Plastic			
35	Oil screw	SUS304 (EN-X5CrNi18-10)			
36	Lubricant	Paraffin oil (ISO VG15)			
48	Screwed Flange	Plastic + glass fibers			
50	Motor cover	Aluminium die casting			
51	Main cover	SCS13 (DIN GX5CrNi19-10)			
52A	Upper bearing	6201ZZC3			
52B	Lower bearing	6202ZZC3			
53	Motor Protector 380/400/415V-50Hz	KA314-HRXL00 (H.C)			