

## Data sheet HSD2.55S-53

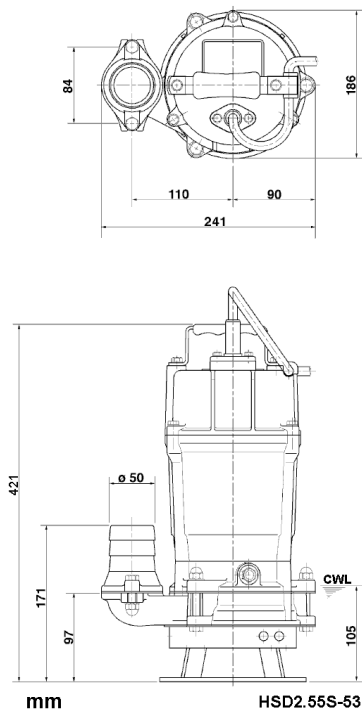

CWL: Continuous running water level

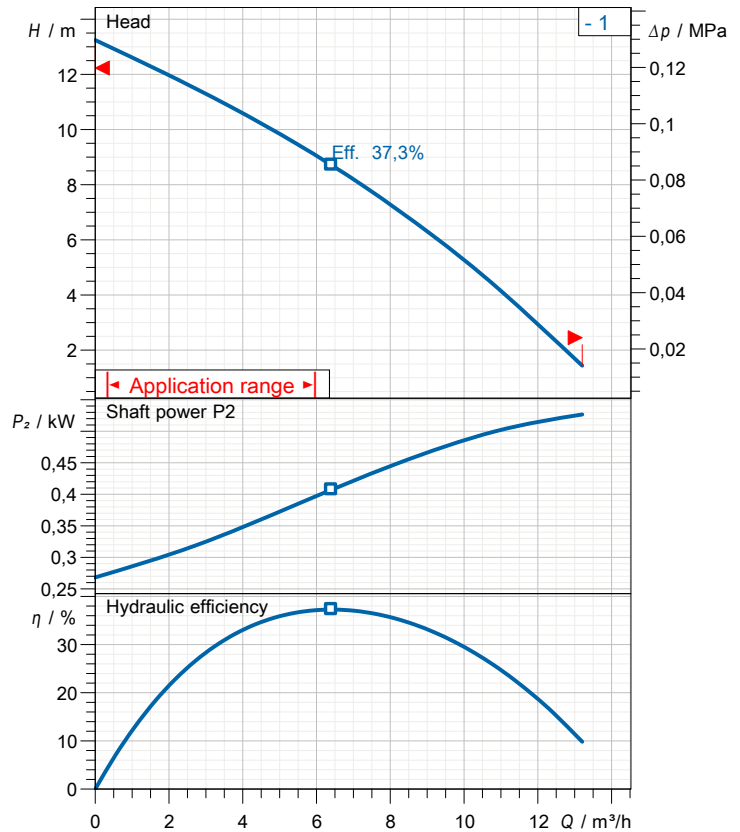

## Specification

Elektrische Tauchpumpe HSD-Serie  
 Degree of protection IP 68  
 Pressure resistance max. 10 m  
 Type of impeller semi-vortex  
 Max. solid handling 10 mm  
 Suitable for:  
 sand carrying water, sludge, bentonite

## Electric motor

Dry-type submersible induction motor  
 Insulation class E 2Poles 2830 1/min  
 Starting mode  
 Rated voltage 230 V 50 Hz 1~  
 Power uptake 0,82 kW  
 Rated power 0,55 kW  
 Rated current 3,4 A  
 Start current

## Cable

10m H07RN-F 3Cx1mm²

## Motor Protection

Circle thermal protector  
 (snap-action bi-metal device)

## Shaft seal

Double inside mechanical seal in oil bath  
 additional lubrication by oil lifting device  
 Primary seal  
 Silicon carbide on silicon carbide  
 Secondary seal  
 Carbon on ceramic

## Bearings

Shielded ball bearings, maintenance-free

## Materials

Impeller	Chromium iron casting
Agitator	Chromium iron casting
Pump casing	FCD700 (EN-GJS-700-2)
Motor Frame	Aluminium die casting
Shaft	SUS403 (EN-X6Cr13)

## Discharge size

2" (50mm) BS-Coupling (threaded flange)

## Weight

14 kg (dry weight of the pump only without cable)

# Performance curve

## HSD2.55S-53

Discharge port	2"
FördH	13,2 m
Flow	13,2 m³/h
Rated power	0,55 kW
Power input	0,82 kW
Phases	1~
Voltages	230 V
Frequency	50 Hz
Rated current	3,4 A
Starting current	
Number of poles	2
Speed	2830 1/min
Starting mode	
Insulation class	E

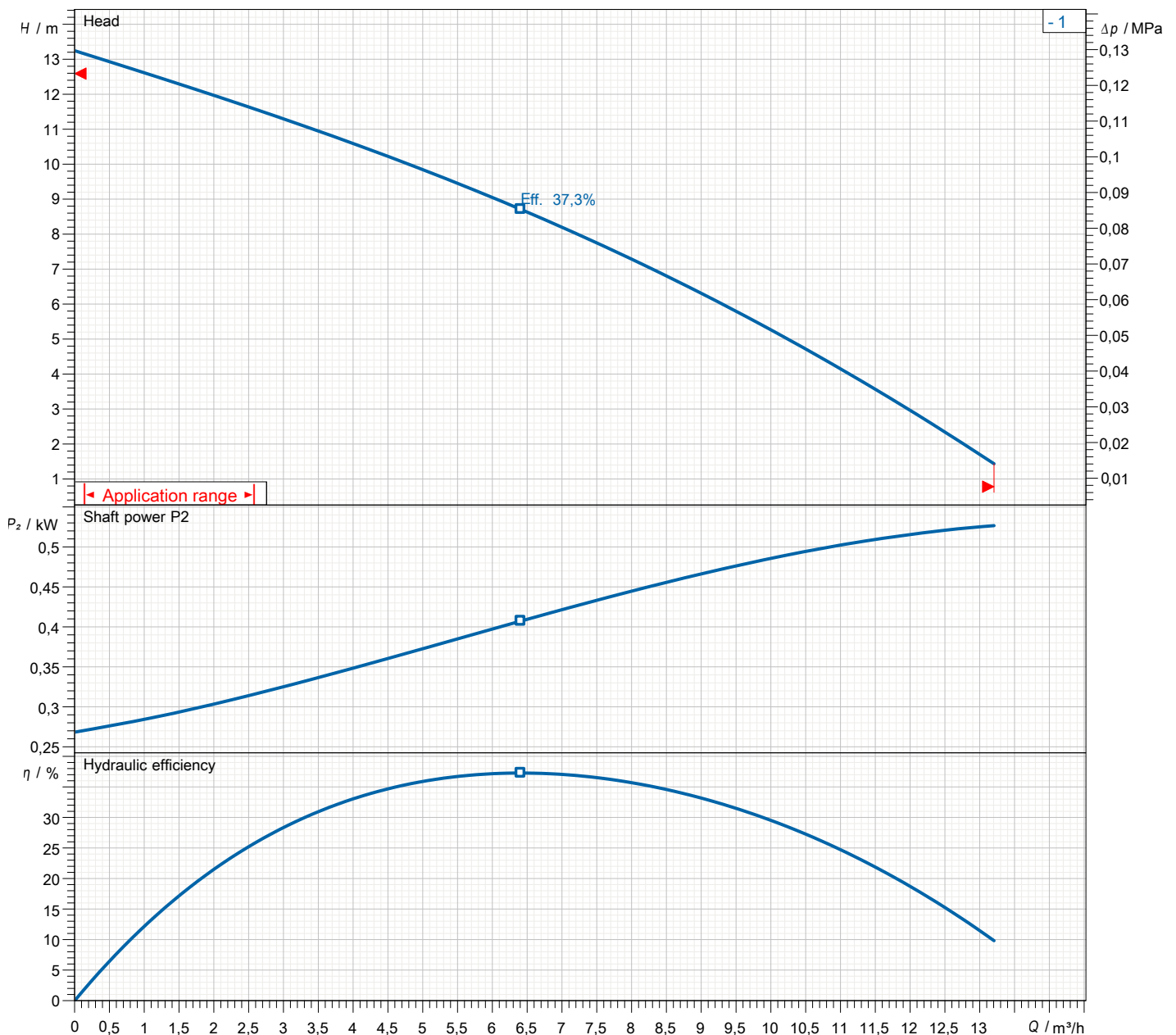

## Dimensions

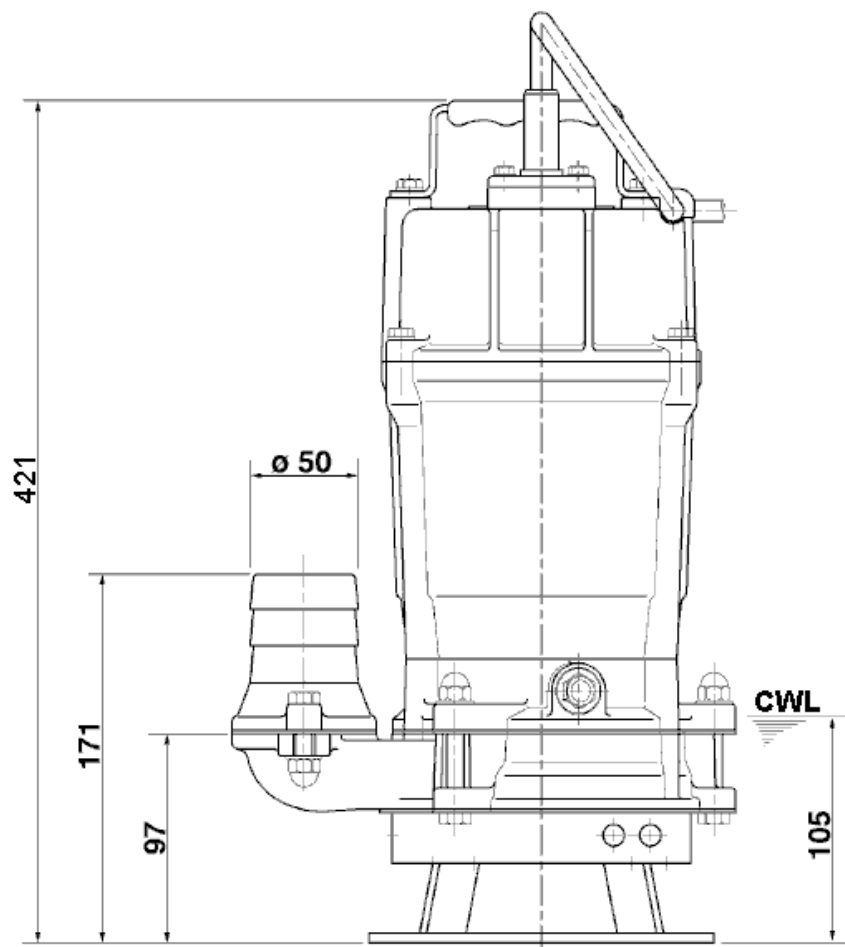
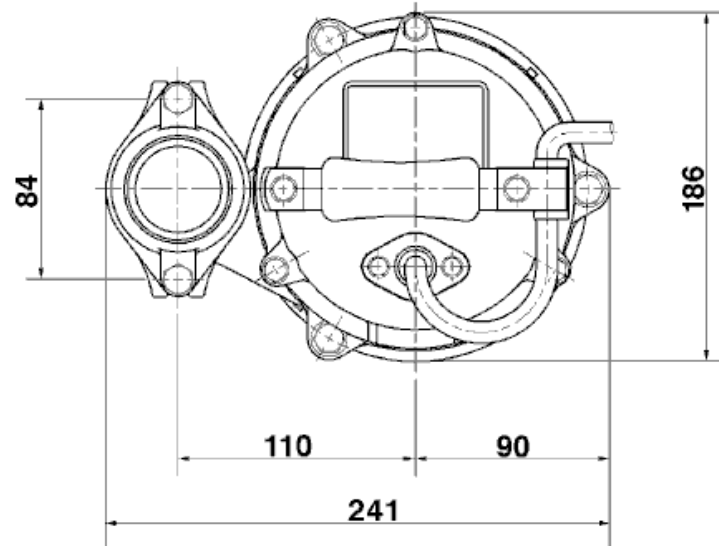

mm

**HSD2.55S-53**

**CWL: Continuous running water level**  
**LWL: Lowest running water level**

# Sectional drawing HSD2.55S-53

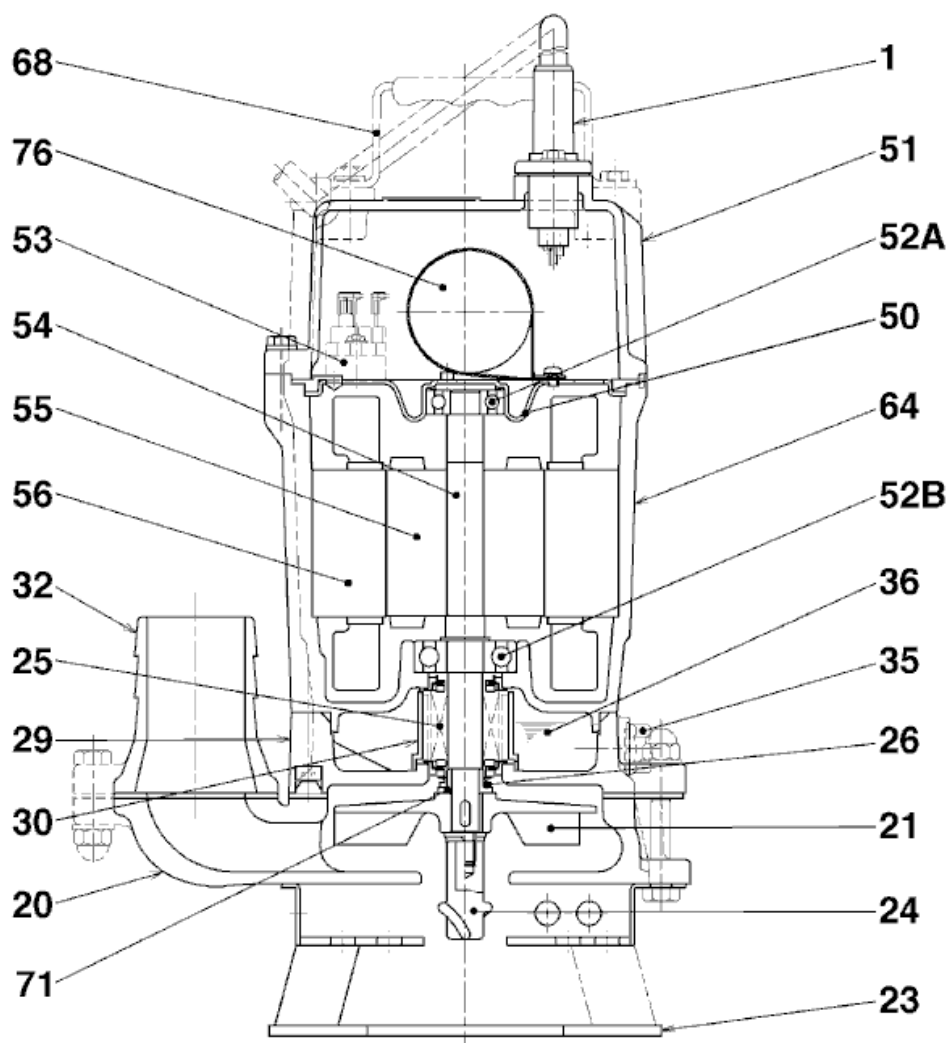

**HSD2.55S-53**

No.	Description	Remark	No.	Description	Remark
1	Cable	H07RN-F3Cx1mm=x10m	53	Motor Protector 380/400/415V-50Hz KA314-HRXL00 (H.C)	
20	Pump casing	FCD700 (EN-GJS-700-2)	54	Shaft	SUS403 (EN-X6Cr13)
21	Impeller	Chromium iron casting	55	Rotor	.
23	Strainer	DIN 1.0040 + steelplate	56	Stator	.
24	Agitator	Chromium iron casting	64	Motor Frame	Aluminium die casting
25	Mechanical seal	W-14VL	68	Handle	Steel plate / natural rubber
26	V-ring	Butadiene-acrylonitrile-rubber	71	Shaft protection sleeve	SUS304 (EN-X5CrNi18-10)
29	Oil casing	FC200 (EN-GJL-200)	76	Condenser	.
30	Oil distributor	Plastic			
32	Discharge coupling	Aluminium die casting			
35	Oil screw	SUS304 (EN-X5CrNi18-10)			
36	Lubricant	Turbine oil (ISO VG32)			
50	Motor cover	Steel plate			
51	Main cover	Aluminium die casting			
52A	Upper bearing	6201ZZC3			
52B	Lower bearing	6302ZZC3			